

## wiper A65

## seal spec

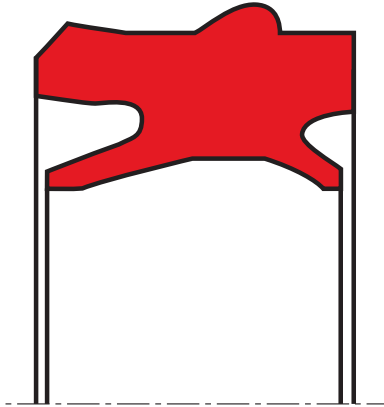

### description

combination wiper seal without metal reinforcement with special pneumatic sealing edge. combines three functions: sealing, wiping, fixing.

### application



### category of profile

molded/standard/trade product or machined with minor design change.

### double acting

#### area of application: pneumatic

- rod seal e.g. for ISO cylinders.
- media: lubricated air as well as dry air and oil-free air (after initial lubrication on assembly).

### advantages

- combination seal with minimal space requirements, which seals inwards and wipes outwards.
- the component needs no additional element (circlip) for axial fixing within the housing.
- long service life.
- robust design.

### operating parameters & material

material	temperature	running surface speed	max. pressure
s-mart PU (90 shore A)	-30 °C ... +80 °C	1 m/s	16 bar (1,6 MPa)
s-mart PU (93 shore A)	-35 °C ... +80 °C	1 m/s	16 bar (1,6 MPa)
s-mart PU (94 shore A)	-30 °C ... +90 °C	1 m/s	12 bar (1,2 MPa)

the stated operation conditions represent general indications. it is recommended not to use all maximum values simultaneously.  
surface speed limits apply only to the presence of adequate lubrication film.

<sup>2</sup> attention: not suitable for mineral oils!

### surface quality

surface roughness	Rtmax (µm)	Ra (µm)
sliding surface	according to seal data	
bottom of groove	≤4	≤0,5
groove face	≤10	≤0,5

**tolerance recommendation**

seal housing tolerances			[mm]	[mm]	[mm]
$\varnothing D$	H11	$\varnothing d$	.....<20	20<.....<50	.....>50
$\varnothing D_1$	H11	R	1,1	1,4	1,8

**fitting & installation**

Careful fitting is a prerequisite for the correct function of the seal. The combination seal A65 is pressed into the housing from outside. The bead on the outside diameter snaps into the circlip groove and fixes the seal in the housing.

**seal & housing recommendations**

Please note that we are able to produce those profiles to your specific need or any non standard housing. For detail measurements, please see seal-mart catalog...

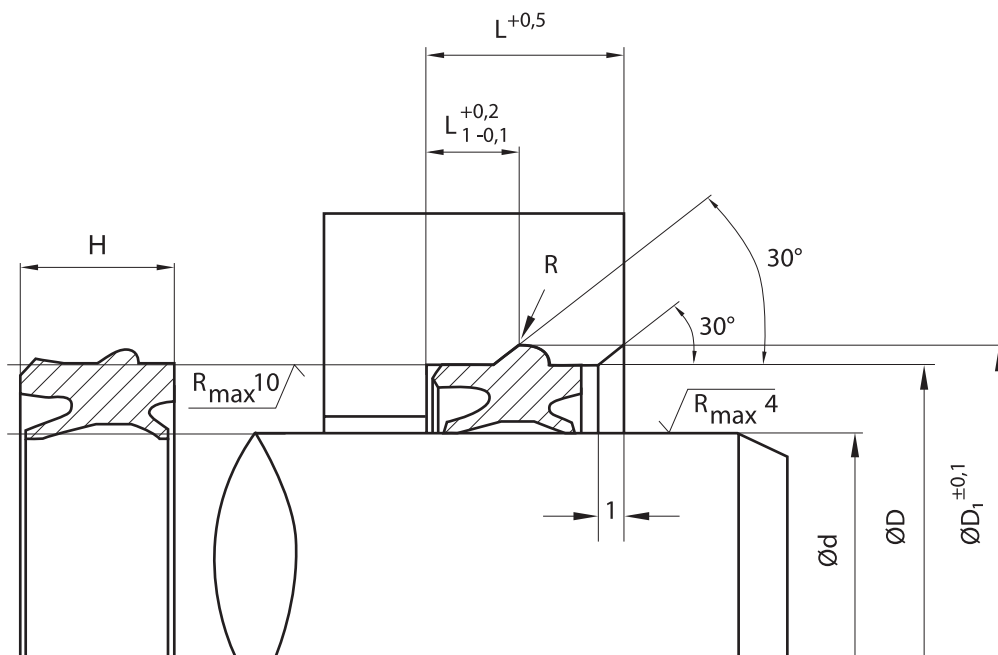

Don't hesitate to contact our technical department for further information or for special requirements (temperature, speed etc.), so that suitable materials and/or designs can be recommended.